

XK1B1SS1FN

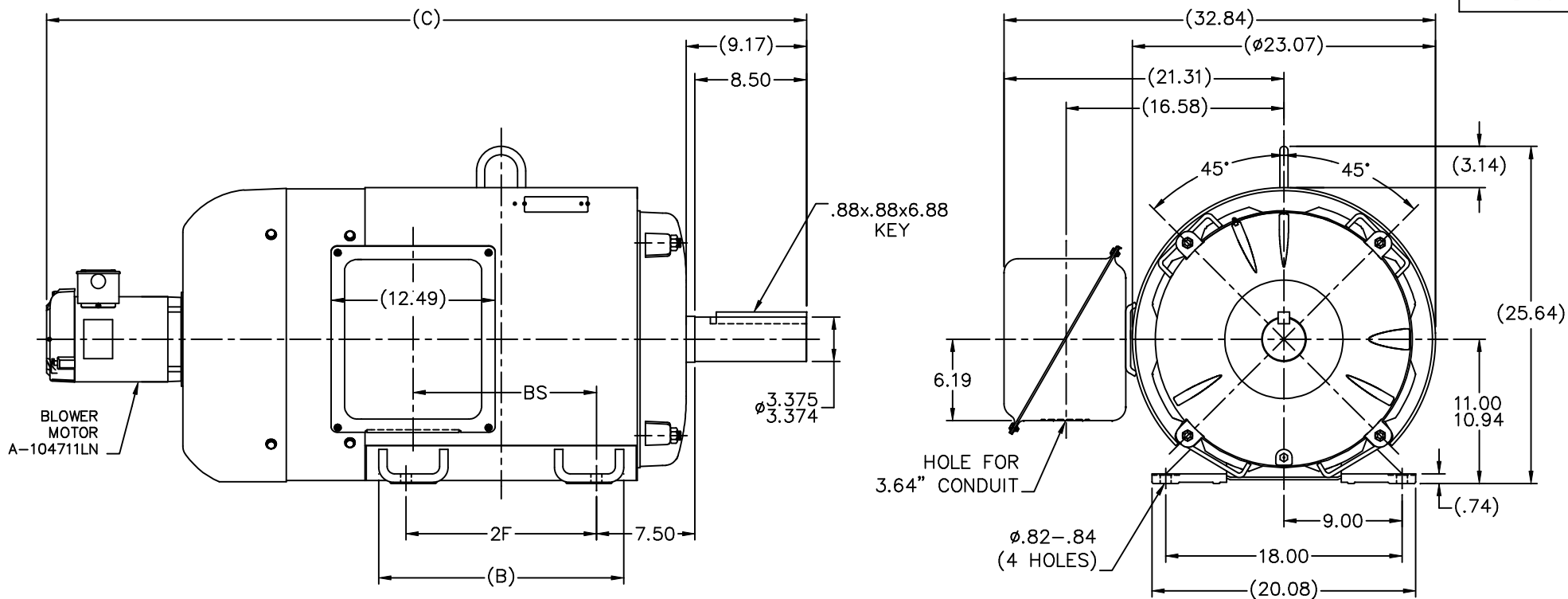

- NOTES:  
 1. CONDUIT BOX CAN BE ROTATED IN 90° STEPS  
 2. NAMEPLATES TO BE READ FROM CONDUIT BOX SIDE OF MOTOR

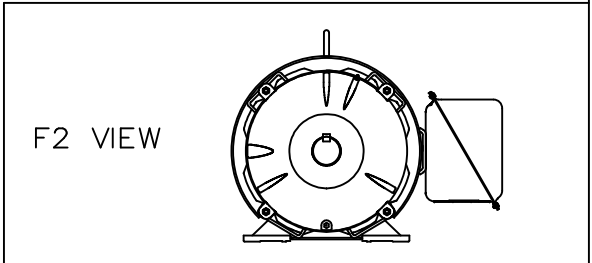

DASH	FRAME	C	BS	B	2F	TOLERANCES UNLESS SPECIFIED				Lincoln MOTOR		DRAWN HLB 02-08-2002						
						DEC.	INCHES					CHK	DRS					
2117	444T	57.85	13.96	18.66	14.50	.X	±.1					APPD	TB					
2317	445T	59.85	15.96	20.66	16.50	.XX	±.03	3	ADDED DRAIN PLUG PER BRACKET CHANGE	CN 37358	MSG 05-07-2004	ML	.XX					
2667	447T	63.35	19.70	23.50	20.00	.XXX	±.005	2	REVISED BLOWER MOTOR PER CN 31970		CTO 01-28-2003	HNH	.XXX					
3167	449T	68.35	23.95	28.50	25.00	.XXXX	±.0005	1	NEW DRAWING	MU40520	HLB 02-11-2002							
						NO.	REVISION	BY & DATE	CHK	ANG	±7'30"	RFP	FINISH					
						THIS DRAWING IN DESIGN AND DETAIL IS OUR PROPERTY AND MUST NOT BE USED EXCEPT IN CONNECTION WITH OUR WORK ALL RIGHTS OF DESIGN AND INVENTION ARE RESERVED THIS IS AN ELECTRONICALLY GENERATED DOCUMENT - DO NOT SCALE THIS PRINT						CAD FILE xk1b1ss1fn		SIZE	DRAWING NO.	PAGE	OF	REV.
												DIST		BY	B	XK1B1SS1FN	3	3

ERROR: syntaxerror  
OFFENDING COMMAND: --nostringval--

STACK:

/initialize  
-dictionary-  
/Pscript\_WinNT\_Compat  
-dictionary-