



A Regal Brand

Catalog # : LM24112

Product Type: AC MOTOR

Description: 1.5,1725,TEFC,56C,3/60/208-230/460

Model: SRF4S1.5TCN61

Stock: Stock

Quote: Price:

Date: 10/14/2014



Hazardous Loc  
Explosion Proof  
Class  
Class

NONE

Temp Op Code  
GROUP  
GROUP

Brake Motors  
FORCE  
VDC  
ADC

Brake Coil OHMs @25 C

Performance  
Torque UOM  
Torque  
CURRENT (amps)  
Efficiency (%)  
PowerFactor

Inertia (WK<sup>2</sup>)

Load Curve Data @60/50 HzVolts,1 1/2Horsepower

Load	Amps	KW	RPM	Torque	Eff	PF	Rise By Resis	Frame Rise
0.0	1.7	0.15	1800	0.0	0.0	10.5	0.0	-
0.25	1.8	0.4	1780	1.1	66.5	29.5	0.0	-
0.5	1.95	0.7	1770	2.2	77.5	46.5	0.0	-
0.75	2.2	1.0	1755	3.4	80.0	60.0	0.0	-
1.0	2.4	1.4	1735	4.5	80.0	74.0	58.0	-
1.15	2.7	1.6	1730	5.2	80.0	75.0	75.0	-
1.25	2.8	1.7	1725	5.7	78.5	76.0	90.0	-
1.2	2.8	1.65	1728	5.4	79.0	75.5	82.0	-

SOURCE: CALCULATED GROUP: 3

Load Curve Data @60/50HzVolts,1 1/2Horsepower

Load	Amps	KW	RPM	Torque	Eff	PF	Rise By Resis	Frame Rise
------	------	----	-----	--------	-----	----	---------------	------------

Load Curve Data Not Available

Quote: Price:

Date: 10/14/2014

100103LN

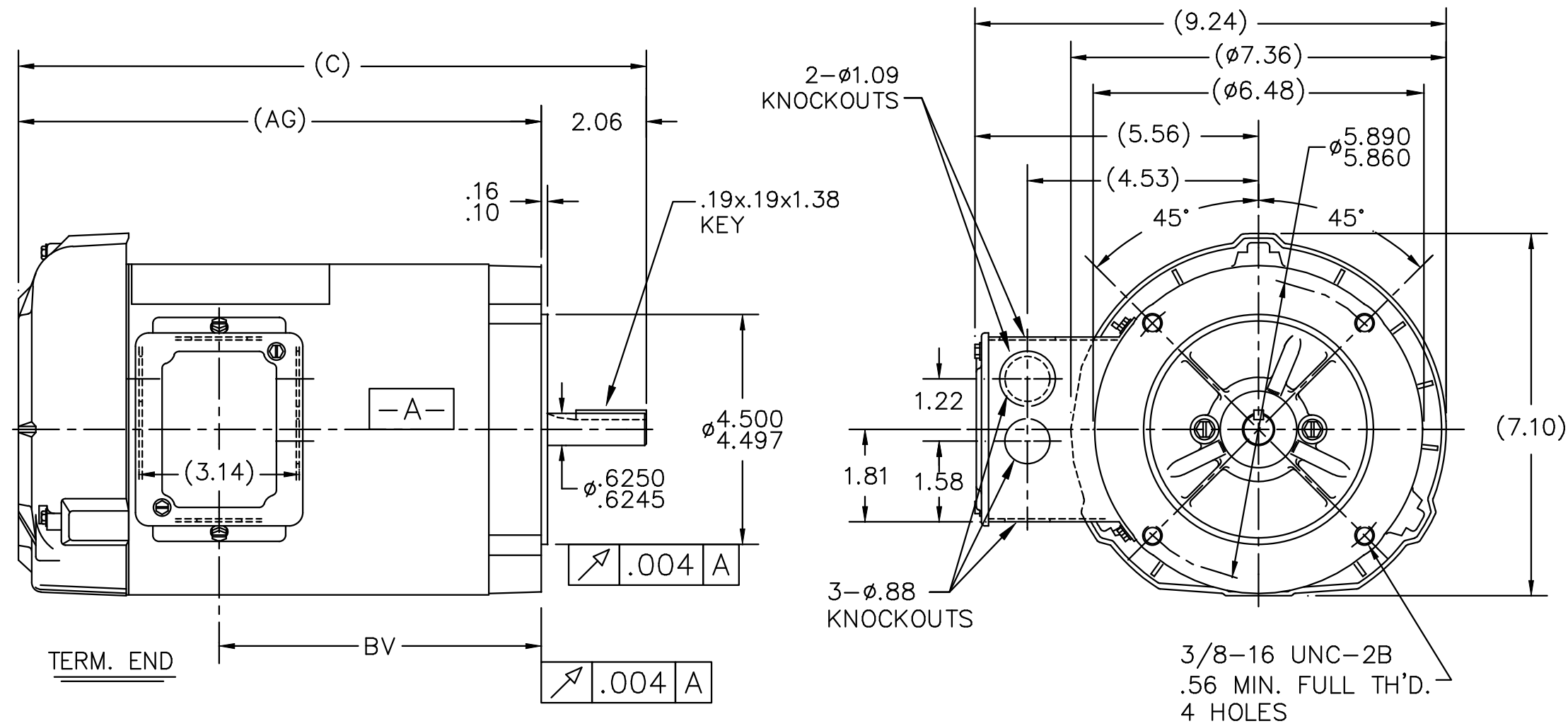

- NOTE:
1. NAMEPLATE READ FROM CONDUIT BOX SIDE.
  2. METAL NP READ FROM TERM END.

DASH	FR.	C	AG	BV	DASH	FR.	C	AG	BV
606	56-60	11.32	9.25	5.31	806	56-80	13.32	11.25	7.31
656	"-65	11.82	9.75	5.81	856	"-85	13.82	11.75	7.81
706	"-70	12.32	10.25	6.31	906	"-90	14.32	12.25	8.31
756	"-75	12.82	10.75	6.81	956	"-95	14.82	12.75	8.81

		TOLERANCES UNLESS SPECIFIED				DRAWN RWR 03/11/2004	
		DEC.	INCHES			CHK ML 03/12/2004	
		.X	±.1			APPD GK 03/12/2004	
3	ADDED NOTE & 2	CN29200-3978	RJW 01-13-2005	.XX	±.03	SCALE 5=16	
2	DELETED NOTES 2 & 3		RJW 10-18-2004	.XXX	±.005	REF CN32620	
1	REVISED NAMEPLATE NOTE.	MU50676	NJS 05-11-2004	ML .XXXX	±.0005	FMF	
NO.	REVISION	BY & DATE	CHK	ANG	±1/2"	FINISH	PREV
THIS DRAWING IN DESIGN AND DETAIL IS OUR PROPERTY AND MUST NOT BE USED EXCEPT IN CONNECTION WITH OUR WORK ALL RIGHTS OF DESIGN AND INVENTION ARE RESERVED THIS IS AN ELECTRONICALLY GENERATED DOCUMENT - DO NOT SCALE THIS PRINT			RFP	CAD FILE 100103ln		SIZE A	DRAWING NO. PAGE 1 OF 1 REV. 3
			DIST WP			100103LN	



THREE PHASE  
DUAL VOLTAGE MOTOR

EE7308-LN

HIGH VOLTAGE

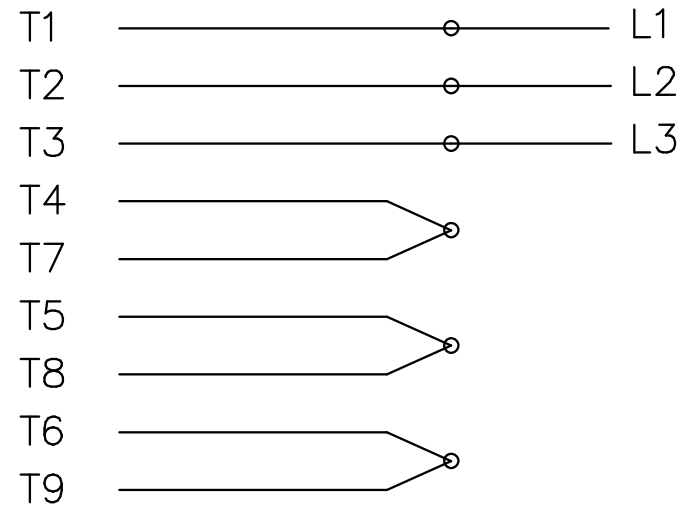

LOW VOLTAGE

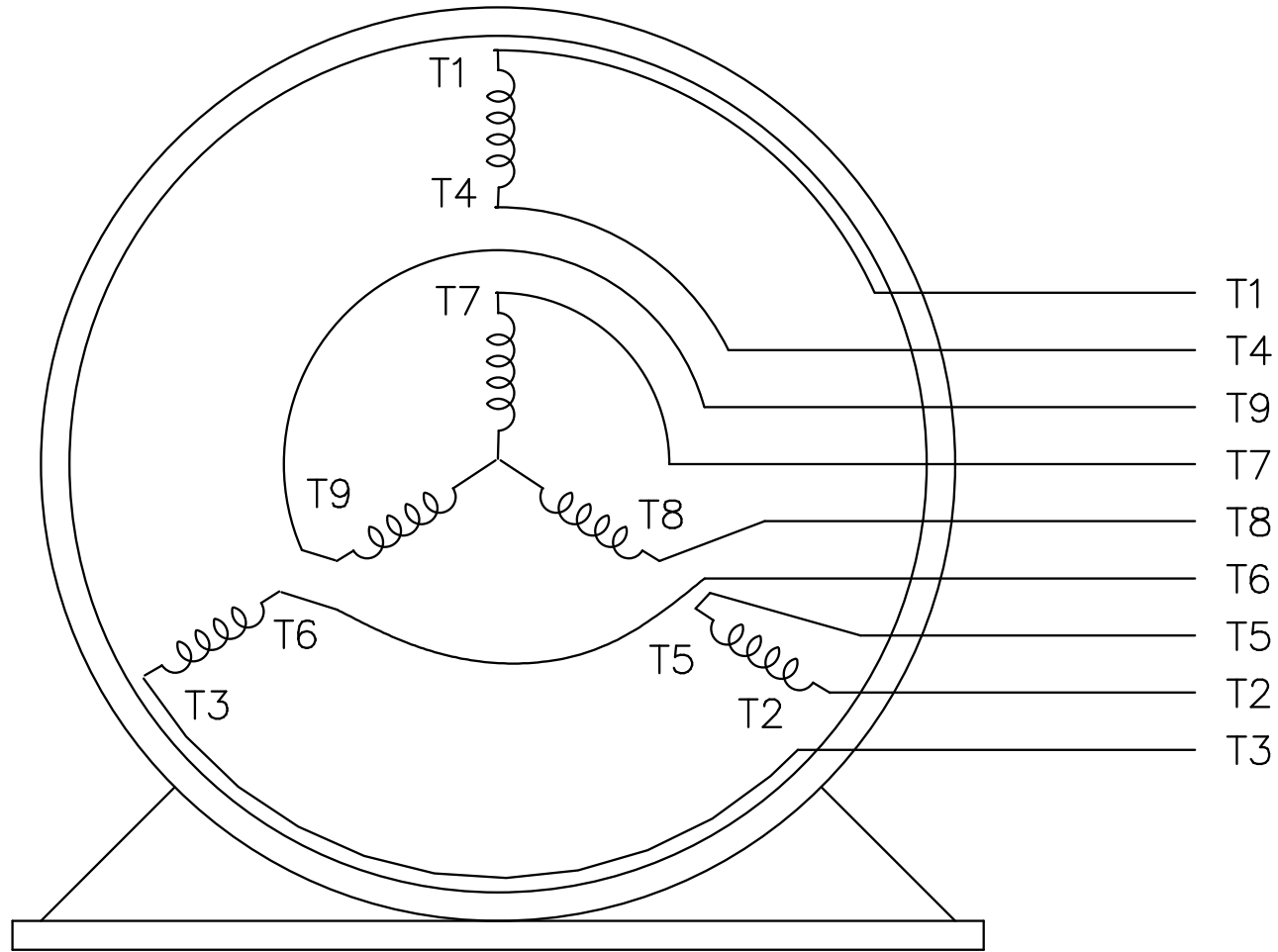
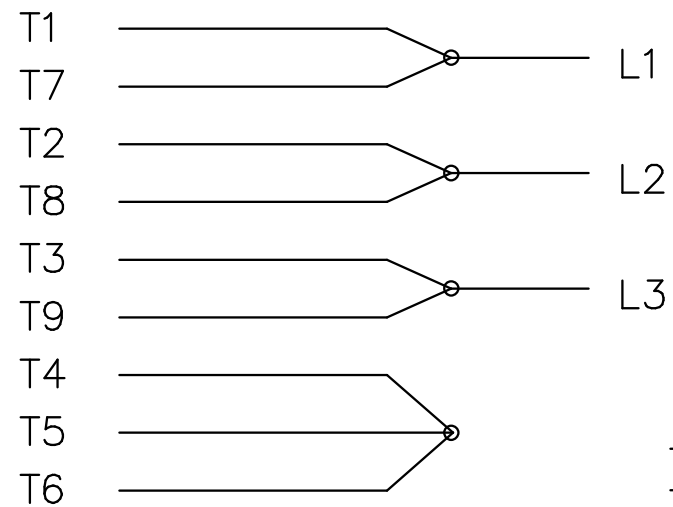

VIEW OF TERMINAL END

REF.  
WINDING DIAGRAM

T8Y, T2Y, T2BL, T4BX, T2EC, T2G  
T6BZ, T2B, T6BL, T4AV, T6B, T4B

OPTIONAL CORD  
CONNECTION

L1 WHITE  
L2 RED  
L3 BLACK

NO.	REVISION	BY & DATE	CHK	TOLERANCES UNLESS SPECIFIED		FINISH	DRAWN BLR 06/11/1999
				DEC.	INCHES		
				.X	±.1		CHK ML 06/18/1999
3	ADDED THE OPTIONAL CORD CONNECTION MU46318	RDH 04/24/2003	DRS	.XX	±.02	TITLE CONNECTION DIAGRAM	APPD GK 06/18/1999
2	RE-ISSUE, ADDED '-' TO PART NUMBER	BLR 08/09/1999	GK	.XXX	±.005	3φ - DUAL VOLTAGE MOTOR	SCALE 1=1
1	NEW DRAWING	BLR 06/18/1999	GK	.XXXX	±.0005	MAT'L.	REF
				ANG	±7'30"		FMF
THIS DRAWING IN DESIGN AND DETAIL IS OUR PROPERTY AND MUST NOT BE USED EXCEPT IN CONNECTION WITH OUR WORK ALL RIGHTS OF DESIGN AND INVENTION ARE RESERVED THIS IS AN ELECTRONICALLY GENERATED DOCUMENT - DO NOT SCALE THIS PRINT				RFP	CAD FILE EE7308LN	SIZE A	DRAWING NO. EE7308-LN
				DIST WP			PAGE OF 3
							REV. 3

